



Quality on wheels

Wheels and Casters



Industry - Office - Home



**VISIT OUR
WEB PAGE**

TABLE OF CONTENT

	Page
Roller	1
Terminology	2
Lightweight capacity Series #19 - 21 - 30 - 35 - 36 -39 -110 wheels in polypropylene, Rubber injection & vulanaized, nylon	3
Lightweight capacity Series # 110 -16 wheels in polypropilene, Rubber inyection, Polypropylene and Polyurethane	4
Medium load capacity Series #21 wheels in polyurethane, Rubber inyection & vulcanized, nylon Rubber wheel with stamped steel wheel,	5
Medium load capacity Series #25 wheels in nylon, polypropylene.	6
Medium load capacity Series # 25, 26 wheels in Nylon, fiber polyamide, fiber polyamide, Black Polypropylene and rubber	7
Medium load capacity Series # 26, 27 wheels in Nylon and Rubber, Polypropylene and Rubber, Rubber inyection.	8
Medium load capacity series # 27. Wheels in polypropylene.	9
Medium load capacity series # 27, 28. Wheels in Nylon, Fyber with Polyamide, Polyolefin and Nylon or PP, Rubber and steel, Polyurethane, Polyamide with Vulcanized Rubber	10
Heavy load capacity series # 40, 41 Wheels in rubber (vulcanized & injection), polyamide and nylon, polyurethane, polyurethane, polyolefin,	11
RHC Wheels 3", 4", 5", 6", 8" or 10"	12
Heavy load capacity series # 40 - 41Wheels in polyamide & fiber, rubber, polypropylene and polyurethane, polypropylene, nylon, polypropylene and polyurethane.	13
Series #44 Wheels in polyurethane and polypropylene, polyolefin and nylon or PP, polypropylene	14
Series #44 Wheels in polyamide with Vulcanized Rubber, fiber with polyamide, Series #44 support.	15
Heavy load capacity series # 41- 43 - 51. Wheels in polyamide & fiber, rubber, polypropylene and polyurethane, polyamide and rubber, polypropylene and nylon, polyamide and polyurethane. Heavy load capacity series #51. Wheels aluminum and polyurethane, aluminum and rubber	16
Support Series # 40, 41, 44, 51	17
Wheels Light weight capacity rubber injection, Medium weight capacity wheels in polyurethane, polypropylene and rubber, rubber, nucleus, rubber injection, vulcanized rubber.	18
Heavy weight capacity. Wheels in polyamide with fiber reinforcement. Heavy load capacity series wheels in nylon, polypropylene, polyurethane, polyolefin & polypropylene, santoprene & polypropylene, rubber & nylon, rubber, rubber and polyamide.	19
Heavy load capacity polyamide with fiber reinforcement wheels	20
Super heavy weight load capacity wheels in aluminium and rubber, polyamide and polyurethane, aluminum and polyurethane, pneumatic and pallet jack	20
Levelers, sliders and trollyes	21
Bed legs / Sofa legs	22



The Roller brand was established by Multipartes on the year 1976. Since then, our focus has been on supplying high quality rollers and casters for the OEM industry and the after market. Our quality control is in agreement with the norm ICONTEC ISO 9001:2015.

Multipartes has been manufacturing wheels and casters for over 40 years specializing in supplying the industry and after market sales throughout Central America and South America. With over 400 employees and 430,000 Sq feet, Multipartes has earned as a manufacturer, the recognition for its quality throughout the markets where it has presence. Multipartes is 100% autonomous on its production processes and all our products are backed with a certificate of origin.



1. SWIVEL CASTER

- D: Exterior diameter of the wheel
- b: Width of the wheel
- B: Width of the wheel nucleus
- h: Total height of caster
- c: Platform Width
- e: Length of platform
- f: Distance between holes (center to center)
- g: Distance between holes (center to center)

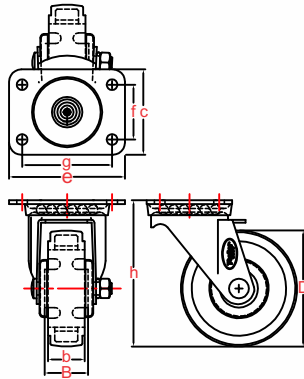

2. RIGID CASTER

- D: Exterior diameter of the wheel
- b: Width of the wheel
- B: Width of the wheel nucleus
- h: Total height of caster
- c: Platform Width
- e: Length of platform
- f: Distance between holes (center to center)
- g: Distance between holes (center to center)

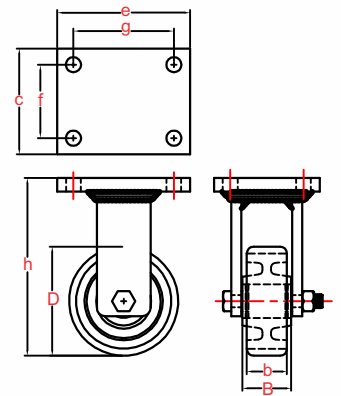

3. STEM CASTERS (threaded and non-threaded)

- D: Exterior diameter of the wheel
- b: Width of the wheel
- B: Width of the wheel nucleus
- h: Total height of caster
- L: Length of stem
- d: Diameter of stem

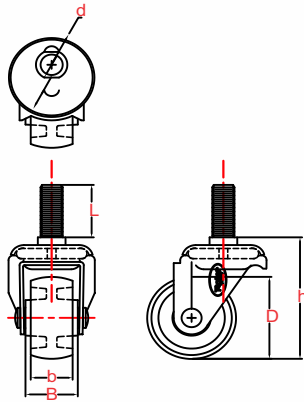

4. RECTANGULAR PLATFORM FORKS FOR CASTERS

- h: Total height of caster
- c: Platform Width
- e: Length of platform
- f: Distance between holes (center to center)
- g: Distance between holes (center to center)

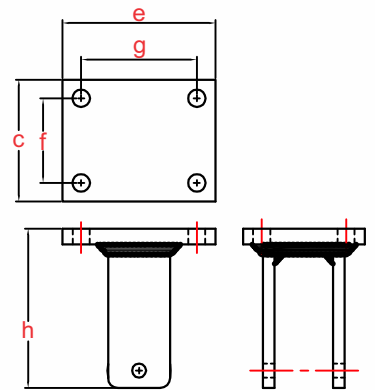

5. WHEELS

Width of Band

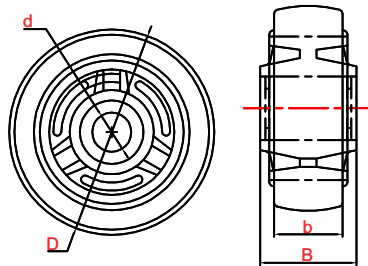

6. LEVLERS AND SLIDERS

- D: Base diameter
- h: Height of leveler until maximum insertion point
- d: Stem diameter
- L: Length of max insertion

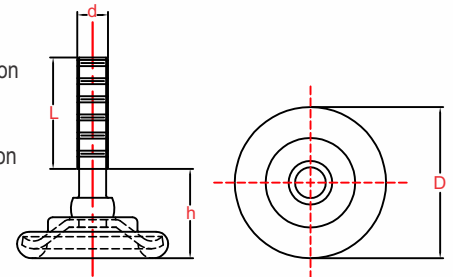

7. TROLLIES

- L: Length of trolley
- A: Width of trolley
- h: Total height of trolley
- c: Depth of trolley cargo base
- e: Width of trolley cargo base

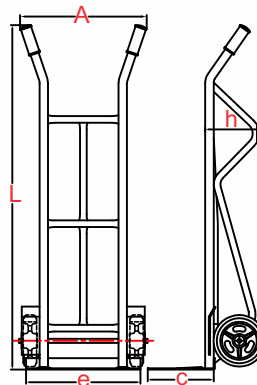



USES: Filing Cabinets, Auxiliary Beds, Displays, Cabinets, Baffles, Racks, Suitcases, Lecterns.

19 SERIES PP Polypropylene

Steel base support. polypropylene Wheel

Finish: Zinc finish

Diameter Wheel: 2"

Mounting Type: platform

Max Load capacity: 110 lbs



21 SERIES PP Polypropylene

Steel base support. polypropylene Wheel

Finish: Zinc finish

Diameter Wheel: 1", 1 1/4", 1 1/2"
Wheel: 1 3/4", 2".

Mounting Type: platform, screw and others

Max Load capacity: 26.4 - 55 lbs

Ø 1 3/4" Optional, with Brake



21 SERIES PP Polypropylene

Steel base support. polypropylene Wheel

Finish: Zinc finish

Diameter Wheel: 1", 1 1/4",
Wheel: 2", 2 1/2"

Mounting Type: platform, screw and others

Max Load capacity: 26.4 - 55 lbs

Ø 1 3/4" Optional, with Brake



21 SERIES PP Polypropylene

Steel base support. polypropylene Wheel

Finish: Zinc finish

Diameter Wheel: 1 1/2"

Mounting Type: Curved platform

Max Load capacity: 26.4 - 55 lbs



Applications: Curved equipment, Showcases, furniture, filing cabinets.



30 SERIES PPI

Plastic Nylon support, Nylon wheel.

Diameter Wheel: 2"

Mounting Type: Square platform

Max Load capacity: 66 lbs



30 SERIES PPI

Plastic Nylon support, Nylon wheel.

Diameter Wheel: 2"

Mounting Type: Spike, Square

Max Load capacity: 66 lbs



30 SERIES PP Polypropylene

Plastic Nylon support, polypropylene wheel

Diameter Wheel: 1 5/8"

Mounting Type: platform, screw and others

Max Load capacity: 44 - 66 lbs



30 SERIES PP Polypropylene

Plastic Nylon support, polypropylene wheel.

Diameter Wheel: 1 5/8", 2"

Mounting Type: platform, screw and others

Max Load capacity: 44 - 66 lbs



36 SERIES PP Polypropylene

Plastic Nylon support, polypropylene wheel.

Diameter Wheel: 2"

Mounting Type: Spike, platform,

Max Load capacity: 44 - 66 lbs

Applications: Furniture, Chairs.



39 SERIES PP Polypropylene

Plastic Nylon support, polypropylene wheel.

Diameter Wheel: 1 1/2"

Mounting Type: Spike, platform and others

Max Load capacity: 33 lbs.

Applications: Furniture, table tv.





Lightweight Capacity

USOS: Filing Cabinets, Auxiliary Beds, Displays, Cabinets, Baffles, Racks, Suitcases, Lecterns.

110 SERIES PPI Rubber Injection

Steel support. Rubber Wheel (injection)

Finish: Zinc finish

Diameter
Wheel: 2"

Mounting
Type: Platform, screw.

Max Load
capacity: 33 - 110 lbs



110 SERIES PP Polypropylene

Steel support. polypropylene Wheel

Finish: Zinc finish

Diameter 1", 1 1/4",
Wheel: 1 5/8", 1 3/4",
2"

Mounting
Type: Platform, Spike,
screw, Coupling

Max Load
capacity: 33 - 110 lbs



110 SERIES PP Polypropylene

Steel support. polypropylene Wheel

Finish: Zinc finish

Diameter 1", 1 1/4",
Wheel: 1 5/8", 1 3/4",
2"

Mounting
Type: Platform, Spike,
screw, Coupling

Max Load
capacity: 33 - 110 lbs



SERIES 16 POLYPROPYLENE AND POLYURETHANE

Medium Weight Load Capacity

Steel support.
Polypropylene and poliurethane Wheel

Finish: Zinc finish

Diameter Wheel: 1", 1 1/4", 1 5/8", 1 3/4", "2"

Mounting Type: Platform.

Max Load capacity: 77 - 176 lbs



G16P30PPU1.5BI



G16P30PPU1.5BTI

Total Brake

1.5"

Max Load
Capacity:
77 lb.



G16P30PPU2BI



G16P30PPU2BTI

Total Brake

2"

Max Load
Capacity:
110 lb.



G16P31PPU3BTI



G16P31PPU3BI

Total Brake

3"

CAPACIDAD
CARGA x UNID.
176 lb.

USES: Shelves, Showcases, Displays, Filing cabinets, Refrigerators, Conveyor Trolleys, Bottle Racks, Cabinets, Kitchen Furniture.



Medium weight load capacity

Applications: Transport carts, Displays, Showcases, Shelves, Refrigerators, Filing cabinets, Bottle racks, Stretchers

21 SERIES PPU Polyurethane

Stamped steel fork & base support, double pellet track 360° rotation,
Wheel Option: Polyurethane, rubber, rubber injection
Option: with / without brake

Finish: Zinc finish

Diameter Wheel: 3"

Mounting Options: Threaded stem, steel platform, on threaded stem with rubber couplings.

Max Load capacity: 110 lbs



21 SERIES PPU Polyurethane

Stamped steel fork & base support, double pellet track 360 Rotation or fixed.

Finish: Zinc finish

Diameter Wheel: 4"

Mounting Options: Threaded stem, steel platform, on threaded stem with rubber couplings.

Max Load capacity: 110 lbs



21 SERIES PP Rubber Injection

Stamped steel fork & base support, double pellet track 360 Rotation or fixed

Finish: Zinc finish

Diameter Wheel: 3"

Mounting Options: Threaded stem, steel platform, on threaded stem with rubber couplings.

Max Load capacity: 110 lbs



21 SERIES TC Rubber wheel with stamped steel wheel

Stamped steel fork & base support, double pellet track 360 Rotation only or fixed Vulcanized rubber wheel

Finish: Zinc finish

Diameter Wheel: 3", 4"

Mounting Options: Threaded stem, steel platform, on threaded stem with rubber couplings.

Max Load capacity: 110 lbs



21 SERIES N Nylon

Stamped steel fork & base support, double pellet track 360 Rotation or fixed

Finish: Zinc finish

Diameter Wheel: 2", 2 1/2"

Mounting Options: Threaded stem, steel platform, on threaded stem with rubber couplings.

Max Load capacity: 55 lbs



21 SERIES PPF Rubber Injection

Stamped steel fork & base support, double pellet track 360 Rotation or fixed

Finish: Zinc finish

Wheel Option: Polyurethane, rubber, rubber injection

Diameter Wheel: 3"

Mounting Options: Threaded stem, steel platform, on threaded stem with rubber couplings.

Max Load capacity: 55 lbs

Option: with / without brake



21 SERIES TC Rubber wheel with stamped steel wheel

Stamped steel fork & base support, double pellet track 360 Rotation only.
Vulcanized rubber wheel

Wheel brake

Finish: Zinc finish

Diameter Wheel: 3", 4"

Mounting Options: Threaded stem, steel platform, on threaded stem with rubber couplings.

Max Load capacity: 110 lbs



21 SERIES PPI Rubber Injection

Stamped steel fork & base support, double pellet track 360 rotation or fixed.

With pedal brake

Wheel Option: Polyurethane, rubber, rubber injection

Finish: Zinc finish

Diameter Wheel: 3"

Mounting Options: Threaded stem, steel platform, on threaded stem with rubber couplings.

Max Load capacity: 110 lbs

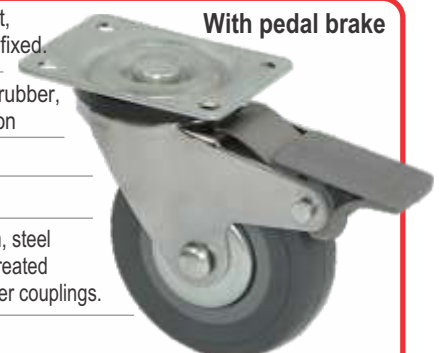



Medium weight load capacity

Applications: Conveyor Carts, Displays, Showcases, Shelves, Refrigerators, Filing Cabinets, Bottle Racks

25 SERIES N Nylon Wire Brake

Stamped steel fork & base support, double pellet track

Support: 360 Rotation or fixed
Steel Finish: Zinc or powder coat

Diameter Wheel: 2", 2 1/2"

Mounting Options: Threaded stem, steel platform rectangular or U shape, threaded stem with rubber couplings

Max Load capacity: 165 lbs.



25 SERIES Nylon

Stamped steel fork & base support,

Support: Fixed
Steel Finish: Zinc or powder coat

Diameter Wheel: 2"

Mounting Options: Steel rectangular platform

Max Load capacity: 165 lbs.



25 SERIES Nylon Total Brake

Stamped steel fork & base support,

Support: Fixed
Steel Finish: Zinc or powder coat

Diameter Wheel: 2"

Mounting Options: Steel rectangular platform, screw.

Max Load capacity: 165 lbs.

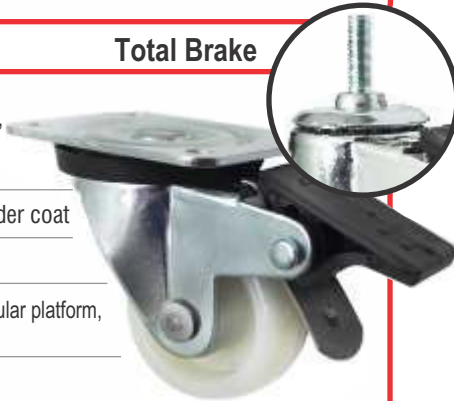

25 SERIES PP Polipropylene Total Brake

Stamped steel fork & base support, double pellet track

Support: 360 Rotation.
Steel Finish: Zinc or powder coat

Diameter Wheel: 2", 2 1/2"

Mounting Options: Screw, Threaded stem, steel platform rectangular or U shape, threaded stem

Max Load capacity: 165 lbs.



25 SERIES PP Polipropylene Wire Brake

Stamped steel fork & base support, double pellet track

Support: 360 Rotation.
Steel Finish: Zinc or powder coat

Diameter Wheel: 2", 2 1/2"

Mounting Options: Threaded stem, steel platform rectangular or U shape, threaded stem

Max Load capacity: 165 lbs.



25 SERIES PP Polipropylene

Stamped steel fork & base support, double pellet track

Support: 360 Rotation.
Steel Finish: Zinc or powder coat

Diameter Wheel: 2", 2 1/2"

Mounting Options: Threaded stem, steel platform rectangular or U shape, threaded stem

Max Load capacity: 165 lbs.



25 SERIES PP Polipropylene Wire Brake

Stamped steel fork & base support, double pellet track

Support: 360 Rotation.
Steel Finish: Zinc or powder coat

Diameter Wheel: 2", 2 1/2"

Mounting Options: Threaded stem, steel platform rectangular or U shape, threaded stem

Max Load capacity: 165 lbs.



25 SERIES PP Polipropylene Total Brake

Stamped steel fork & base support, double pellet track

Support: 360 Rotation.
Steel Finish: Zinc or powder coat

Diameter Wheel: 2", 2 1/2"

Mounting Options: Screw, Threaded stem, steel platform rectangular or U shape, threaded stem

Max Load capacity: 165 lbs.





Medium weight load capacity

Applications: Conveyor Carts, Displays, Showcases, Shelves, Refrigerators, Filing Cabinets, Bottle Racks

25 SERIES N Nylon

Wire Brake

Stamped steel fork & base support, double pellet track
Support: 360 Rotarion or fixed.

Optiont: with / without brake

Steel Finish Zinc or powder coat

Diameter Wheel: 2", 2 1/2"

Mounting Options: Threaded stem, steel platform rectangular or U shape, threaded stem



Max Load capacity: 165 lbs.

25 SERIES H Fyber Polyamide

Stamped steel fork & base support, double pellet track

Support: 360 Rotarion or fixed

Steel Finish: Zinc or powder coat

Diameter Wheel: 2", 2 1/2"

Mounting Options: Threaded stem, steel platform rectangular or U shape, threaded and non threaded stem.

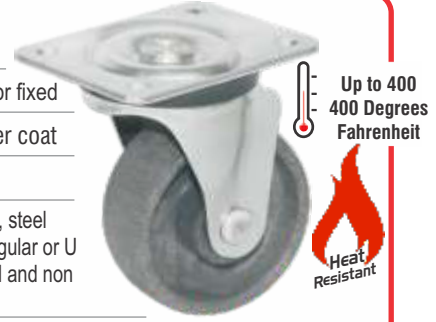

Max Load capacity: 176 lbs. Applications: Oven carts (commercial bakery)

25 SERIES H Fyber Polyamide / Black

Stamped steel fork & base support, double pellet track

Support: 360 Rotarion or fixed

Steel Finish: Zinc or powder coat

Diameter Wheel: 2", 2 1/2"

Mounting Options: Threaded stem, steel platform rectangular or U shape, threaded and non threaded stem.



Max Load capacity: 176 lbs. Applications: Oven carts (commercial bakery),

25 SERIES H Fyber Polyamide

Stamped steel fork & base support, double pellet track

Support: 360 Rotarion or fixed

Steel Finish: Zinc or powder coat

Diameter Wheel: 2", 2 1/2"

Mounting Options: Threaded stem, steel platform rectangular or U shape, threaded and non threaded stem.



Max Load capacity: 176 lbs. Applications: Oven carts (commercial bakery),

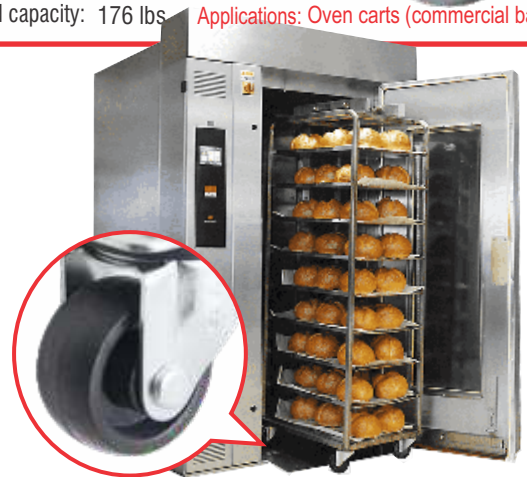

APPLICATIONS: Stretchers, Wheelchairs, Hospital Beds, Clinics, Laboratories

26 SERIES PPC Polypropylene and rubber

Nylon injection support, double pellet track
360 Rotarion

Wheel composite: Vulcanized rubber:

Diameter Wheel: 5"

Mounting Options: Stem non threaded



26 SERIES PPC Polypropylene and Rubber

Total brake

Nylon injection support, double pellet track
360 Rotarion with total brake

Wheel composite: Vulcanized rubber:

Diameter Wheel: 5"

Mounting Options: Stem non threaded

Max Load capacity: 220 lbs.





Medium weight load capacity

Applications: Stretchers, Wheelchairs, Hospital Beds, Clinics, Laboratories

26 SERIES NC Nylon and Rubber Total brake

Nylon injection support, double pellet track
360 Rotation with total brake

Wheel composite: Rubber injection

Diameter Wheel: 6"

Mounting Options: Stem non threaded

Max Load capacity: 330 lbs.



26 SERIES NC Nylon and Rubber

Nylon injection support, double pellet track
360 Rotation.

Wheel composite: Rubber injection

Diameter Wheel: 6"

Mounting Options: Stem non threaded

Max Load capacity: 330 lbs.



27 SERIE NC Nylon and Rubber

Stamped steel fork and support, double pellet track
360 Rotation or fixed

Wheel composite: Rubber injection

Steel Finish: Zinc or powder coat

Diameter Wheel: 6"

Mounting Options: Stem non threaded 1", 1 1/4"

Max Load capacity: 286 lbs.



27 SERIE NC Nylon and Rubber Total Brake

Stamped steel fork and support, double pellet track
360 Rotation with total Brake or fixed.

Wheel composite: Rubber injection

Steel Finish: Zinc or powder coat

Diameter Wheel: 6"

Mounting Options: Stem non threaded 1", 1 1/4"

Max Load capacity: 286 lbs.



Applications: Stretchers, Wheelchairs, Hospital Beds, Clinics, Laboratories, Shelves, Displays, Hotel Trollyes, Transport Carts

27 SERIES PPC Polypropylene and Rubber

Stamped steel fork and support, double pellet track
360 Rotation

Wheel composite: Rubber injection or Polypropylene

Steel Finish: Zinc or powder coat

Diameter Wheel: 5"

Mounting Options: Threaded stem, steel platform
rectangular shape,
non-threaded stem with
rubber couplings.

Max Load capacity: 220 lbs.



27 SERIES PPC Polypropylene and Rubber Pedal break

Stamped steel fork and support, double pellet track
360 Rotation with pedalbrake or fixed.

Wheel composite: Rubber injection or Polypropylene

Steel Finish: Zinc or powder coat

Diameter Wheel: 5"

Mounting Options: Threaded stem, steel platform
rectangular shape,
non-threaded stem with
rubber couplings.

Max Load capacity: 220 lbs.

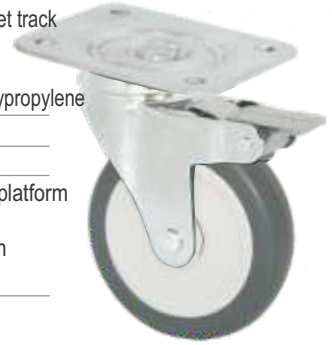

27 SERIES TC Steel and Rubber wheel, Pedal Brake

Stamped steel fork and support, double
pellet track 360 Rotation with pedal brake.

Wheel composite: Options rubber

Diameter Wheel: 5"

Mounting Options: Threaded stem, steel platform
rectangular shape,
non-threaded stem with
rubber couplings.

Max Load capacity: 132 lbs.



27 SERIES TC Rubber injection Pedal break

Stamped steel fork and support, double pellet track
360 Rotation with pedal brake / without brake.

Wheel composite: Rubber injection

Diameter Wheel: 5"

Mounting Options: Threaded stem, steel platform
rectangular shape,
non-threaded stem with
rubber couplings.

Max Load capacity: 132 lbs.



G27P16PP3P POLIPROPYLENE



Medium weight load capacity



Max Load Capacity: 330 lb.

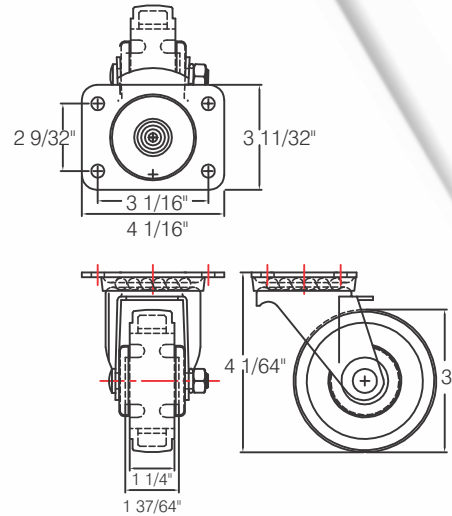

Steel support. polypropylene Wheel
Finish: Zinc finish

Diameter
Wheel: 3"

Mounting
Type: Platform

Max Load
capacity: 330 lbs

Applications: Refrigerators, food grade Furniture,
commercial trolleys, work bench,
commercial use



Total Brake





Medium weight load capacity

Applications: Transport carts, Displays, Showcases, Shelves, Refrigerators, Filing cabinets, Bottle racks, commercial use

27 SERIES N Nylon

Stamped steel fork and support, double pellet track 360 Rotation with pedal brake.

Support: 360 Rotation or fixed

Steel finish: Zinc or powder coat

Diameter Wheel: 3"

Mounting Options: Rectangular steel platform

Max Load capacity: 165 lbs.



27 SERIES H Fyber with Polyamide

Stamped steel fork and support, double pellet track 360 Rotation.

Support: 360 Rotation.

Steel finish: Zinc or powder coat

Diameter Wheel: 3"

Mounting Options: Rectangular steel platform

Max Load capacity: 198 lbs.

Applications: oven carts (commercial bakery)



Up to 400
400 Degrees
Fahrenheit



28 SERIES PPF Polyolefin and Nylon or PP

Stamped steel fork and support, double pellet track 360 Rotation .

Support: 360 Rotation.

Steel finish: Zinc or powder coat

Diameter Wheel: 4"

Mounting Options: Rectangular steel platform

Max Load capacity: 165 lbs.

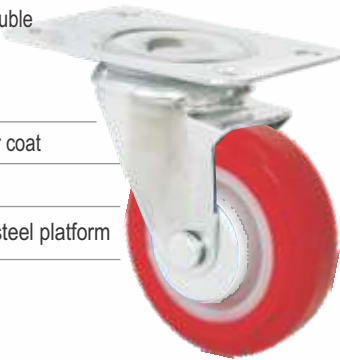

28 SERIES PPU Polyurethane Pedal Brake

Stamped steel fork and support, double pellet track 360 Rotation with pedal brake.

Support: 360 Rotation or fixed

Steel finish: Zinc or powder coat

Diameter Wheel: 4"

Mounting Options: Rectangular steel platform

Max Load capacity: 132 lbs.

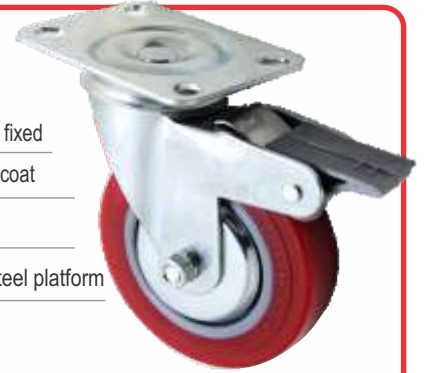

28 SERIES TC Rubber and Steel Pedal Brake

Stamped steel fork and support, double pellet track 360 Rotation with pedal brake.

Support: 360 Rotation or fixed

Steel finish: Zinc or powder coat

Diameter Wheel: 4"

Mounting Options: Rectangular steel platform

Max Load capacity: 132 lbs.



28 SERIES TC Rubber and steel

Stamped steel fork and support, double pellet track 360 Rotation .

Support: 360 Rotation.

Steel finish: Zinc or powder coat

Diameter Wheel: 4"

Mounting Options: Threaded stem, steel platform rectangular shape, non-threaded stem with rubber couplings

Max Load capacity: 132 lbs.



28 SERIES N Nylon

Stamped steel fork and support, double pellet track 360 Rotation with pedal brake.

Support: 360 Rotation or fixed

Steel finish: Zinc or powder coat

Diameter Wheel: 3"

Mounting Options: Rectangular steel platform

Max Load capacity: 132 lbs.

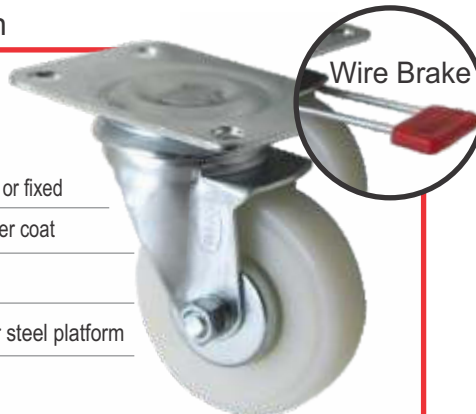

Wire Brake

28 SERIES HC Polyamide with Vulcanized Rubber

Stamped steel fork and support, double pellet track 360 Rotation with pedal brake.

Support: 360 Rotation or fixed

Steel finish: Zinc or powder coat

Diameter Wheel: 3"

Mounting Options: Rectangular steel platform

Max Load capacity: 132 lbs.

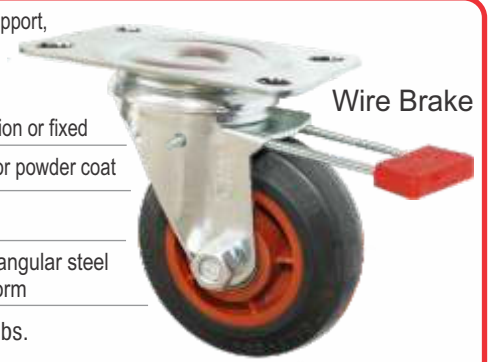

Wire Brake



Heavy Weight Load Capacity

Applications: Food grade equipment, industrial trolleys, commercial trolleys, work bench, industrial use furniture, food / grocery carts

40 SERIES NC Nylon Wheel with Rubber Band

Stamped & welded steel fork / base support, double pellet track. Detachable system for easy maintenance

Support:	360 Rotation of fixed.
Steel finish:	Zinc or powder coat
Diameter Wheel:	6", 8"
Mounting Options:	Steel platform
Max Load capacity:	330 - 440 lbs.

Applications: Refrigerators, beach trolleys,



40 SERIES HC Polyamide with Vulcanized Rubber

Stamped & welded steel fork / base support, double pellet track. Detachable system for easy maintenance.

Support:	360 Rotation of fixed.
Steel finish:	Zinc or powder coat
Diameter Wheel:	8", 10"
Mounting Options:	Steel platform
Max Load capacity:	1.100 lbs.



40 SERIES HC Polyamide Wheel with Rubber Band

Stamped & welded steel fork / base support, double pellet track. Detachable system for easy maintenance

Support:	360 Rotation of fixed.
Steel finish:	Zinc or powder coat
Diameter Wheel:	4", 5", 6", 8"
Mounting Options:	Steel platform
Max Load capacity:	440 - 1.100 lbs.

Applications: Heavy weight industrial trolleys,



40 SERIES PPU Polyurethane

Stamped & welded steel fork / base support, double pellet track. Detachable system for easy maintenance.

Support:	360 Rotation of fixed.
Steel finish:	Zinc or powder coat
Diameter Wheel:	4", 6", 8"
Mounting Options:	Steel platform
Max Load capacity:	440 - 1.100 lbs.

Applications: Heavy load, construction equipment



40 SERIES PPU Polyurethane

Stamped & welded steel fork / base support, double pellet track. Detachable system for easy maintenance

Support:	360 Rotation of fixed with or w/o wheel brake
Steel finish:	Zinc or powder coat
Diameter Wheel:	6"
Mounting Options:	Steel platform, unthreaded, threaded stem
Max Load capacity:	880 lbs.

Applications: Scaffolds, construction



40 SERIES PPF Polyolefin

Stamped & welded steel fork / base support, double pellet track. Detachable system for easy maintenance.

Support:	360 Rotation of fixed.
Steel finish:	Zinc or powder coat
Diameter Wheel:	4", 6", 8"
Mounting Options:	Steel platform
Max Load capacity:	880 lbs.

Applications: Heavy load Refrigerators,



40 SERIES N Nylon

Stamped & welded steel fork / base support, double pellet track. Detachable system for easy maintenance

Support:	360 Rotation of fixed.
Steel finish:	Zinc or powder coat
Diameter Wheel:	4", 5", 6", 8"
Mounting Options:	Steel platform
Max Load capacity:	330 - 1.100 lbs.



40 SERIES HU Polyamide with Poliurethane Band

Stamped & welded steel fork / base support, double pellet track. Detachable system for easy maintenance.

Support:	360 Rotation or fixed.
Steel finish:	Zinc or powder coat
Diameter Wheel:	4", 5", 6", 8"
Mounting Options:	Steel platform
Max Load capacity:	660 - 1.100 lbs.



The new generation of industrial and commercial wheels



RHC WHEEL 3",4",5",6", 8" OR 12"



**QUALITY
REASONS
THAT SET US
DIFFERENT!!!**

● BEARING AND STEEL BUSHING

● NEEDLE ROLLER.

● 100% RUBBER BAND
(DIFFERENTIAL IN THE SMELL)

● LIGHT WEIGHT.

● NON-CORROSIVE.

Max Load
Capacity for unit:

Ø 3" 220 lbs.

Ø 4" 660 lbs.

Ø 5" 770 lbs.

Ø 6" 880 lbs.

Ø 8" 1.100 lbs.

Ø 10" 1.300 lbs.

Ø 12" 1.500 lbs.





Heavy Weight Load Capacity

Applications: Food grade equipment, industrial trolleys, commercial trolleys, work bench, industrial use furniture, food / grocery carts

40 SERIES H Fyber with Polyamide

Stamped & welded steel fork / base support, double pellet track
Detachable system for easy maintenance.

Support:	360 Rotation or fixed.
Steel finish:	Zinc or powder coat
Diameter Wheel:	4", 5", 6", 8"
Mounting Options:	Steel platform
Max Load capacity:	660 - 1.100 lbs.

Applications: Oven carts (commercial bakery),



Up to 400 Degrees Fahrenheit



40 SERIES PP Polypropylene

Stamped & welded steel fork / base support, double pellet track.
Detachable system for easy maintenance.

Support:	360 Rotation or fixed.
Steel finish:	Zinc or powder coat
Diameter Wheel:	4", 5", 6", 8"
Mounting Options:	Steel platform
Max Load capacity:	660 - 1.100 lbs.

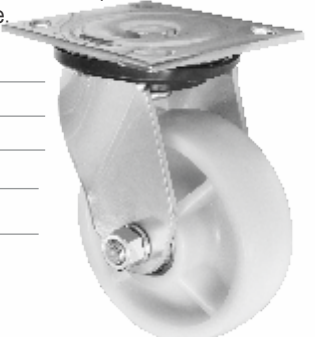

41 SERIES HU Polyamide with Poliurethane Band

Stamped & welded steel fork / base support, double pellet track. Detachable system for easy maintenance

Support:	360 Rotation or fixed.
Steel finish:	Zinc or powder coat
Diameter Wheel:	4", 6", 8"
Mounting Options:	Steel platform
Max Load capacity:	330 - 1.100 lbs.



41 SERIES NC Nylon Wheel with Rubber Band

Stamped & welded steel fork / base support, double pellet track.
Detachable system for easy maintenance.

Support:	360 Rotation or fixed.
Steel finish:	Zinc or powder coat
Diameter Wheel:	6", 8"
Mounting Options:	Steel platform
Max Load capacity:	330 - 440 lbs.

Applications: Industrial trolleys, Refrigerators, beach trolleys,



41 SERIES PPU polyurethane and polypropylene

Stamped & welded steel fork / base support, double pellet track.
Detachable system for easy maintenance.

Support:	360 Rotation or fixed.
Steel finish:	Zinc or powder coat
Diameter Wheel:	4", 5", 6", 8"
Mounting Options:	Steel platform
Max Load capacity:	440 - 1.100 lbs.

Applications: Construction equipment, commercial trolleys,



41 SERIES Nylon

Stamped & welded steel fork / base support, double pellet track.
Detachable system for easy maintenance.

Support:	360 Rotation or fixed.
Steel finish:	Zinc or powder coat
Diameter Wheel:	4", 5", 6", 8"
Mounting Options:	Steel platform
Max Load capacity:	440 - 1.100 lbs.

Applications: Food grade equipment, refrigerators, industrial trolleys,



41 SERIES H Fyber with Polyamide

Stamped & welded steel fork / base support, double pellet track
Detachable system for easy maintenance.

Support:	360 Rotation or fixed.
Steel finish:	Zinc or powder coat
Diameter Wheel:	4", 5", 6", 8"
Mounting Options:	Steel platform
Max Load capacity:	660 - 1.100 lbs.

Applications: Oven carts (commercial bakery),



Up to 400 Degrees Fahrenheit



41 SERIES PP Polypropylene

Stamped & welded steel fork / base support, double pellet track.
Detachable system for easy maintenance.

Support:	360 Rotation or fixed.
Steel finish:	Zinc or powder coat
Diameter Wheel:	4", 5", 6", 8"
Mounting Options:	Steel platform
Max Load capacity:	440 - 1.100 lbs.

Applications: Food grade equipment, refrigerators,





PPU polyurethane and polypropylene

Stamped & welded steel fork / base support, double pellet track.
Detachable system for easy maintenance.

Support: 360 Rotation or fixed.

Steel finish: Power coat chrome.

Diameter Wheel: 4", 5", 6"

Mounting Options: Steel platform, Stem 1"

Max Load capacity: 440 - 1.100 lbs.

Applications: Construction equipment, commercial trolleys, industrial use, supermarkets, heavy load trolleys.

G44P19PPU4BFT



G44P19PPU6BFT



F44P19PPU4B



G44P19PPU5BFT

PPF Polyolefin and Nylon or PP

Stamped & welded steel fork / base support, double pellet track.
Detachable system for easy maintenance.

Support: 360 Rotation or fixed.

Steel finish: Power coat chrome.

Diameter Wheel: 4", 5", 6"

Mounting Options: Steel platform, Stem 1"

Max Load capacity: 440 - 1.100 lbs.

Applications: Refrigerators, food grade Furniture, commercial trolleys, work bench, commercial use.

G44P19PPF4BFT



G44P19PPF6BFT

F44P19PPF4B



G44M2PPF4BFT

PP polypropylene

Stamped & welded steel fork / base support, double pellet track.
Detachable system for easy maintenance.

Support: 360 Rotation or fixed.

Steel finish: Power coat chrome.

Diameter Wheel: 4", 5", 6"

Mounting Options: Steel platform, Stem 1"

Max Load capacity: 440 - 1.100 lbs.

Applications: Industrial trolleys, Refrigerators, food industry, food grade equipment, restaurants, bakery, supermarkets.



F44P19PP4B



G44P19PP4BFT



G44M2PP4BFT



HC polyamide with Vulcanized Rubber

Stamped & welded steel fork / base support, double pellet track. Detachable system for easy maintenance.

Support: 360 Rotation or fixed.

Steel finish: Power coat chrome.

Diameter Wheel: 4", 5", 6"

Mounting Options: Steel platform, Stem 1"

Max Load capacity: 440 - 1.100 lbs.

Applications: Food grade equipment, industrial trolleys, commercial trolleys, work bench, industrial use furniture, food / grocery carts.

G44P19HC4BFT

F44P19HC4B

G44P19HC5BFT

G44P19HC6BFT

G44M2HC6BFT



H Fiber with polyamide



Stamped & welded steel fork / base support, double pellet track. Detachable system for easy maintenance.

Support: 360 Rotation or fixed.

Steel finish: Power coat chrome.

Diameter Wheel: 4", 5", 6"

Mounting Options: Steel platform, Stem 1"

Max Load capacity: 440 - 1.100 lbs.

Applications: oven carts (commercial bakery), rolling access stairways, food grade Furniture, commercial trolleys, work bench,

G44P19H4BFT

G44P19H6BFT

F44P19H4B

G44M2H4BFT



Up to 400
400 Degrees
Fahrenheit

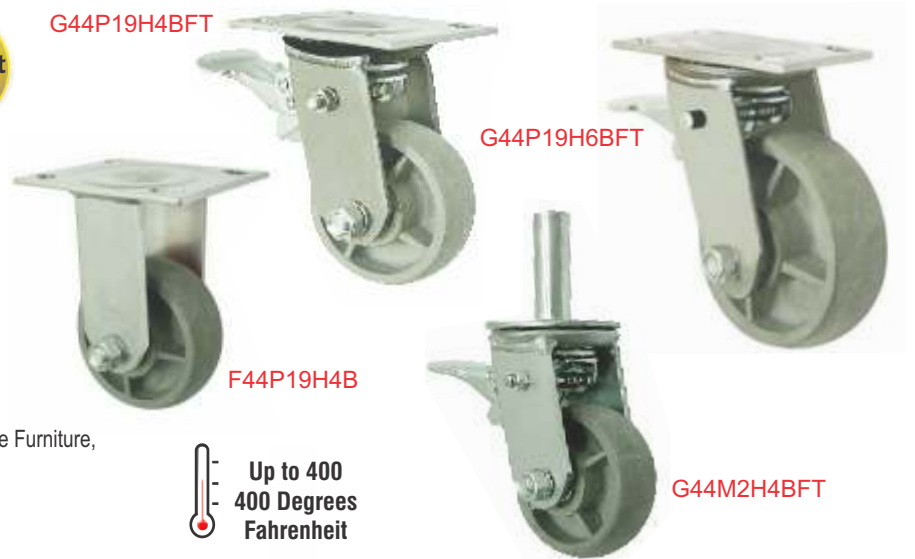

Series 44 Support

Stamped & welded steel fork / base support, double pellet track. Detachable system for easy maintenance.

Support: 360 Rotation or fixed.

Steel finish: Power coat chrome.

Diameter Wheel: 4", 5", 6"

Mounting Options: Steel platform, Stem 1"

Max Load capacity: 440 - 1.100 lbs.

Applications: food grade equipment, industrial trolleys, commercial trolleys, work bench, industrial use furniture, food / grocery carts.

G44P19-6FT

G44M2-6FT

F44P19-6





Heavy Weight Load Capacity / Super Heavy Weight

Applications: Food grade equipment, Comercial Trolleys, Work bench, Industrial use furniture, Shelves

41 SERIES HC Polyamide with Vulcanized Rubber

Stamped & welded steel fork / base support, double pellet track. Detachable system for easy maintenance.

- Support: 360 Rotation or fixed.
- Steel finish: Zinc or powder coat
- Diameter Wheel: 4", 5", 6", 8"
- Mounting Options: Steel platform
- Max Load capacity: 880 - 1.100 lbs.

Applications: Food / grocery carts.



41 SERIES HC Polyamide with Vulcanized Rubber

Stamped & welded steel fork / base support, double pellet track. Detachable system for easy maintenance.

- Support: 360 Rotation with or w/o wheel brake.
- Steel finish: Zinc or powder coat
- Diameter Wheel: 6"
- Mounting Options: Stem 1"
- Max Load capacity: 880 lbs.

Applications: Scaffolds, construction Equipment.

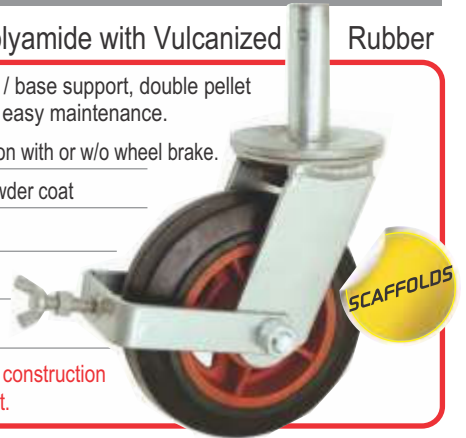

41 SERIES PPF Polyolefin

Stamped & welded steel fork / base support, double pellet track. Detachable system for easy maintenance.

- Support: 360 Rotation of fixed.
- Steel finish: Zinc or powder coat
- Diameter Wheel: 4", 6", 8"
- Mounting Options: Steel platform
- Max Load capacity: 880 lbs.

Applications: Heavy load Refrigerators,



43 SERIES Polipropylene

Stamped & welded steel fork / base support, double pellet track. Detachable system for easy maintenance.

- Support: 360 Rotation
- Steel finish: Zinc or powder coat
- Diameter Wheel: 3"
- Mounting Options: Steel platform
- Max Load capacity: 440 lbs.



Applications: Industrial carts, Food grade equipment, Comercial Trollyes, Work bench, Industrial use furniture

51 SERIES HU Polyamide with Poliurethane Band

SUPER HEAVY LOAD

Support on steel A-36
Axial track on top and conical bearing on bottom
Wheel nucleus on reinforced polyamide with fiber grass. Rolling band on polyurethane

- Support: 360 Rotation or fixed.
- Steel finish: Zinc or powder coat
- Diameter Wheel: 4", 6", 8", 10", 12"
- Mounting Options: Steel platform cal 1/2"

Max Load capacity: 440 - 1.100 lbs.

Applications: Rolling access stairways,

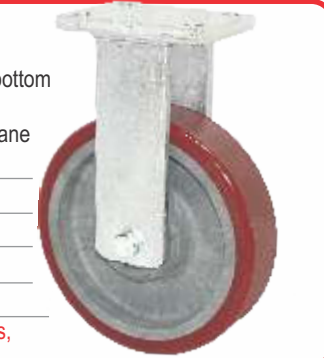

51 SERIES HC Polyamide with Vulcanized Rubber

Stamped & welded steel fork / base support, double pellet track. Detachable system for easy maintenance.

- Support: 360 Rotation of fixed.
- Steel finish: Zinc or powder coat
- Diameter Wheel: 4", 6", 8", 10", 12"
- Mounting Options: Steel platform
- Max Load capacity: 1.100 lbs.

Applications: Food / grocery carts.



51 SERIES HU Aluminum with polyurethane band

SUPER HEAVY LOAD

Support on steel A-36
Axial track on top and conical bearing on bottom
Wheel nucleus in casted aluminum, Rolling band on polyurethane.

- Support: 360 Rotation or fixed.
- Steel finish: Zinc or powder coat
- Diameter Wheel: 4", 6", 8", 10", 12"
- Mounting Options: Steel platform cal 1/2"

Max Load capacity: 2.200 lbs.

Applications: Rolling access stairways



51 SERIES HC Aluminum wheel with vulcanized Rubber

SUPER HEAVY LOAD

Support on steel A-36
Axial track on top and conical bearing on bottom
Wheel nucleus in casted aluminum, Rolling band on polyurethane.

- Support: 360 Rotation
- Steel finish: Zinc or powder coat
- Diameter Wheel: 10", 12"
- Mounting Options: Steel platform cal 1/2"

Max Load capacity: 1.320 - 1.540 lbs.





Applications: Industrial Trolleys, Food grade equipment, Comercial Trolleys, Work bench, Industrial use furniture

40 G SERIES (Rotary)

Stamped & welded steel fork / base support, double pellet track. Detachable system for easy maintenance.

- Support: 360 Rotation.
- Steel finish: Zinc or powder coat
- Diameter Wheel: 4", 5", 6", 8"
- Wheels: For all Type
- Mounting Options: Steel platform
- Max Load capacity: 440 - 1.100 lbs.
- Applications: Food / grocery carts.



40 F SERIES (Fixed)

Stamped & welded steel fork / base support, double pellet track. Detachable system for easy maintenance.

- Support: Fixed
- Steel finish: Zinc or powder coat
- Diameter Wheel: 4", 5", 6", 8"
- Wheels: For all Type
- Mounting Options: Steel platform
- Max Load capacity: 440 - 1.100 lbs.
- Applications: Super heavy load



41 P SERIES (Rotary)

Stamped & welded steel fork / base support, double pellet track. Detachable system for easy maintenance.

- Support: 360 Rotation.
- Steel finish: Zinc or powder coat
- Diameter Wheel: 4", 5", 6", 8"
- Wheels: For all Type
- Mounting Options: Steel platform or 1" stem
- Max Load capacity: 440 - 1.100 lbs.
- Applications: Food / grocery carts.



41 F SERIES (Fixed)

Stamped & welded steel fork / base support, double pellet track. Detachable system for easy maintenance.

- Support: Fixed
- Steel finish: Zinc or powder coat
- Diameter Wheel: 4", 5", 6", 8"
- Wheels: For all Type
- Mounting Options: Steel platform
- Max Load capacity: 440 - 1.100 lbs.
- Applications: Super heavy load



44 F SERIES (Rotary)

Stamped & welded steel fork / base support, double pellet track. Detachable system for easy maintenance.

- Support: 360 Rotation.
- Steel finish: Power coat chrome.
- Diameter Wheel: 4", 5", 6", 8"
- Wheels: For all Type
- Mounting Options: Steel platform or 1" stem
- Max Load capacity: 440 - 1.100 lbs.
- Applications: Food / grocery carts.



44 F SERIES (Fixed)

Stamped & welded steel fork / base support, double pellet track. Detachable system for easy maintenance.

- Support: Fixed
- Steel finish: Power coat chrome.
- Diameter Wheel: 4", 5", 6", 8"
- Wheels: For all Type
- Mounting Options: Steel platform
- Max Load capacity: 440 - 1.100 lbs.
- Applications: Super heavy load



Applications: Industrial Trolleys, Comercial Trolleys, Work bench, Hydraulic Jacks, Industrial use furniture

51 P SERIES (Rotary)

SUPER HEAVY LOAD Support on steel A-36 Axial track on top and conical bearing on bottom wheel nucleus in casted aluminum, Rolling band on polyurethane.

- Support: 360 Rotation.
- Steel finish: Zinc or powder coat
- Diameter Wheel: 4", 5", 6", 8", 10", 12"
- Wheels: For all Type
- Mounting Options: Steel platform or 1" stem
- Max Load capacity: 440 - 1.100 lbs.
- Applications: Super heavy load



51 F SERIES (Fixed)

SUPER HEAVY LOAD Support on steel A-36

- Support: Fixed
- Steel finish: Zinc or powder coat
- Diameter Wheel: 6", 8"
- Wheels: For all Type
- Mounting Options: Steel platform cal 1/2"
- Max Load capacity: 440 - 1.100 lbs.
- Applications: Super heavy load





RPPI Inject Rubber

Wheel diameter x band width

Wheel Diameter	Band width (rolling surface)	Load Capacity
3	1. 7/8	88 lbs



Applications: Flatbeds, wheel chair, medical equipment
Exhibitors, supermarket carts,

RPPU Polyurethane

Wheel diameter x band width

Wheel Diameter	Band width (rolling surface)	Load Capacity
3	7/8	132 lbs



Applications: Exhibitors, supermarket carts, trolleys,
residential and commercial use.

RPPC Polypropylene wheel with vulcanized Rubber band

Bearing: Double ball bearing
Wheel diameter x band width

Wheel Diameter	Band width (rolling surface)	Double ball bearing	Load Capacity
5	1. 1/4	bearing	220 lbs



Applications: Hospital equipment, furniture,
supermarkets, shelves, commercial use

RPPC Polypropylene and rubber band

Wheel in polypropylene and rubber band for industrial use.

Wheel diameter x band width

Wheel Diameter	Band width (rolling surface)	bearing	Load Capacity
6	1. 3/8	polyacetal	132 lbs
7	1. 3/8	bushing	132 lbs
8	1. 3/8	bushing	132 lbs



Applications: Construction carts, supermarket carts,
trolleys, residential and commercial use, gardening.

RPPI Inject Rubber

Polypropylene wheel with rubber injection band
Wheel diameter x band width

Wheel Diameter	Band width (rolling surface)	Bearing	Load Capacity
6	1. 1/4	Ball Bearing	176 lbs
7	1. 1/4	Ball Bearing	176 lbs
8	1. 1/4	Ball Bearing	220 lbs



Applications: Flatbeds, wheel chair,
medical equipment.

RC 100% Vulcanized Rubber

Wheel diameter x band width

Wheel Diameter	Band width (rolling surface)	bearing	Load Capacity
4	1. 1/4	polyacetal	132 lbs.
5	1. 1/4	bushing	154 lbs.
6	1. 1/4	bushing	176 lbs



Applications: Compressors, supermarket carts,
trolleys, residential and commercial use, gardening.

RHC Polyamide wheel with vulcanized Rubber band

Bearing: Double ball bearing
Wheel diameter x band width

Wheel Diameter	Band width (rolling surface)	Bearing	Load Capacity
3	1 1/4	Ball Bearing	180 lbs



Applications: Commercial equipment,
construction, supermarkets,
shelves, commercial use

RH Polyamide with fiber glass

50% fiber glass reinforcement
Wheel diameter x band width

Wheel Diameter	Band width (rolling surface)	Bearing	Load Capacity
4	1. 3/8	Ball Bearing	660 lbs
5	1. 5/8	Ball Bearing	880 lbs
6	2	Ball Bearing	1.100 lbs
8	2	Ball Bearing	1.980 lbs

Up to 400
400 Degrees
Fahrenheit



Applications: oven carts
(commercial bakery)
Refrigerators, food grade
Furniture, commercial
trolleys, work bench





Heavy Weight Load Capacity / Wheels

RN 100% Nylon

Bearing: Polyacetal bushing or ball bearing
Wheel diameter x band width

Wheel Diameter	Band width (rolling surface)	bearing	Load Capacity
4	1. 3/8	polyacetal bushing	440 lbs.
4	1. 3/8	Ball Bearing	440 lbs.
6	2	polyacetal bushing	880 lbs.
6	2	Ball Bearing	880 lbs.
7	1. 7/8	Ball Bearing	1100 lbs.
8	1. 7/8	Ball Bearing	1100 lbs.



Applications: Industrial trolleys, Refrigerators, food industry, food grade equipment, hydraulic jacks, restaurants, bakery, supermarkets.

PP Polypropilene

Bearing: Polyacetal bushing or ball bearing
Wheel diameter x band width

Wheel Diameter	Band width (rolling surface)	bearing	Load Capacity
4	1. 3/8	Ball Bearing	440 lbs.
6	2	Ball Bearing	880 lbs.
7	1. 7/8	Ball Bearing	880 lbs.
8	2	Ball Bearing	990 lbs.



Applications: Industrial trolleys, refrigerators, food industry, food grade equipment, hydraulic jacks, restaurants, bakery, supermarkets.

RPPU Polyurethane

Wheel diameter x band width

Wheel Diameter	Band width (rolling surface)	bearing	Load Capacity
3	7/8	polyacetal bushing	132 lbs.
4	7/8	polyacetal bushing	176 lbs.
4	1. 1/8	polyacetal bushing	440 lbs.
5	1. 3/8	polyacetal bushing	660 lbs.
6	1. 3/4	polyacetal bushing	880 lbs.
8	1. 3/4	polyacetal bushing	1100 lbs.



Applications: Exhibitors, supermarket karts, trolleys, commercial use, industrial use.

RPPF Polyolefin with polypropylene band

Wheel diameter x band width

Wheel Diameter	Band width (rolling surface)	bearing	Load Capacity
3	7/8		88 lbs.
4	1. 1/8	Ball Bearing	440 lbs.
4	7/8	polyacetal bushing	176 lbs.
6	1. 3/4	polyacetal bushing	880 lbs.



Applications: Exhibitors, supermarket karts, trolleys, commercial use, industrial use.

RPPB Polypropilene Wheel with santoprene band

Wheel diameter x band width

Wheel Diameter	Band width (rolling surface)	bearing	Load Capacity
6	1. 1/2	polyacetal bushing	176 lbs.
6	2	polyacetal bushing	396 lbs.



Applications: Exhibitors, supermarket karts, trolleys, commercial use, industrial use.

RNC Nylon Wheel with rubber band

Bearing: Polyacetal bushing or ball bearing
Wheel diameter x band width

Wheel Diameter	Band width (rolling surface)	bearing	Load Capacity
6	1. 7/8	Ball Bearing	330 lbs.
8	1. 7/8	polyacetal bushing	440 lbs.
8	1. 7/8	Ball Bearing	440 lbs.
10	2	Ball Bearing	880 lbs.



Applications: Commercial platforms, industrial use, commercial applications, hospitals, industry equipment

RTC Rubber band with steel wheel.

Wheel diameter x band width

Wheel Diameter	Band width (rolling surface)	bearing	Load Capacity
3	1. 5/16	polyacetal bushing	110 lbs.
4	1. 1/8	polyacetal bushing	132 lbs.
5	1. 3/8	polyacetal bushing	132 lbs.



Applications: Compressors, refrigerators, commercial trolleys, work bench, commercial use

RHC Polyamide wheel with vulcanized rubber band

Bearing: roller or ball bearing
Wheel diameter x band width

Wheel Diameter	Band width (rolling surface)	bearing	Load Capacity
4	1.1/4	Ball Bearing	660 lbs.
4	1.1/4	Ball Bearing	660 lbs.
5	1.5/8	Ball Bearing	770 lbs.
6	1.3/4	Ball Bearing	880 lbs.
8	1.3/4	Roller	1100 lbs.
8	1.3/4	Ball Bearing	1100 lbs.
10	1.3/4	Ball Bearing	1300 lbs.
12	1.3/4	Ball Bearing	1500 lbs.



Applications: Commercial equipment, construction, supermarkets, shelves, commercial use



Super Heavy Weight Load Capacity / Wheels

RHC Aluminum casting wheel with vulcanized rubber band

Bearing: Double ball bearing

Wheel Diameter	Band width (rolling surface)	Bearing	Load Capacity
10	2 1/2	Ball Bearing	1320 lbs
12	2 1/2	Roller	1540 lbs



Applications: Hydraulic jacks, trash bin container, Industrial use, industrial equipment, construction.

RHU Polyamide wheel with polyurethane band

SUPER HEAVY WEIGHT SERIES

Bearing: Double ball bearing

Wheel Diameter (rolling surface)	Band width	Bearing	Load Capacity
4	1. 1/2	Ball Bearing	1320 lbs
6	2	Ball Bearing	1980 lbs
8	2	Ball Bearing	2640 lbs



Applications: Hydraulic jacks, trash bin container, Industrial use, industrial equipment, construction.

RHU Aluminum casting wheel with polyurethane band

Super heavy weight series
Bearing: roller or ball bearing
Wheel diameter x band width

Wheel Diameter	Band width (rolling surface)	Bearing	Load Capacity
10	2. 1/2	Ball Bearing	1980 lbs
12	2. 1/2	Ball Bearing	3080 lbs



Applications: Industrial platforms, Industrial use, industrial equipment, construction.

PNEUMATIC TIRE

Wheel Diameter	Description	Bearing	Inches
350 mm	Pneumatics	Bushing	8"



Applications: Buggy carts, construction carts, landscaping equipment

PNEUMATIC TIRE CI

Wheel Diameter	Tarps	Wheel (INCHES)
400 mm	6	8"



Applications: Buggy carts

PNEUMATIC TUBE (INNER)

Diameter
350 mm



Applications: Buggy carts





Levelers and sliders

Trolleys

132-T

Threated stem
3/8 x 1 1/2", 1/4 X 1"

Applications:
Showcases, shelves,
racks, displays,
modular
partitions



134-TC

134-TC Threated stem
1/2" x 1 3/4", 1 1/4"
Material: Rubber

Applications:
Bottle racks, freezers,
filing cabinets,
shelving desks,
displays, modular
partitions



134-T8PP

Threated stem
1/2" x 3 1/4"
Material: Polypropilene

Applications:
Bottle racks, freezers,
filing cabinets,
shelving desks,
displays, modular
partitions



135-GN

Stem Dimensions
5/16" x 1"
Material: Nylon

Applications:
Ergonomic chairs



135-TN

Threated stem 3/8"
Material: Nylon

Applications:
Ergonomic chairs



138-T

Threated stem
5/16" X 1 1/4"
Material: Polypropilene

Applications:
Showcases,
shelves, racks,
displays,
modular
partitions



INDUSTRIAL TROLLEYS

160-026

Load platform: HR steel sheet
Structure: Cold Rolled steel tubing
Wheel: Polyamide with rubber
or nylon.
Wheel
Diameter: 6"
Load
Capacity: 330 lbs.



160-026

160-011

Load platform: HR steel sheet
Structure: Black water steel pipe
Wheel: Polyamide with rubber
or nylon.
Wheel
Diameter: 8"
Load
Capacity: 440 lbs.



160-011

160-012

Load platform: HR steel sheet
Structure: Black water steel pipe
Wheel: Polyamide with rubber
or nylon.
Wheel
Diameter: 8"
Load
Capacity: 880 lbs.

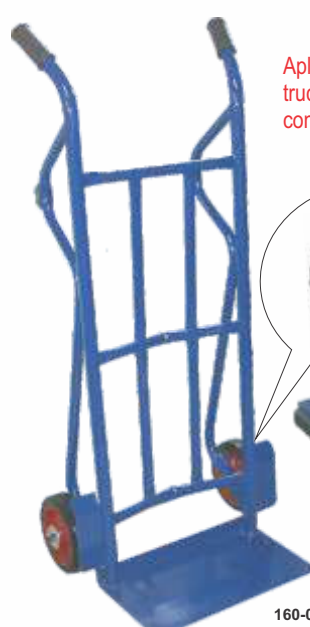

160-012

160-017

Load platform: embossed diamond
steel sheet
Structure: Black water steel pipe
Wheel: Polyamide with rubber
or nylon.
Wheel
Diameter: 6"
Load
Capacity: 2.200 lbs.



160-017

Applications: hipping companies, delivery
trucks, hardware stores, industrial use,
commercial use, residential use.

PRICE
PAGE
8



Bed Legs / Sofa Legs

POWDER COAT FINISH

137L2T29A-8

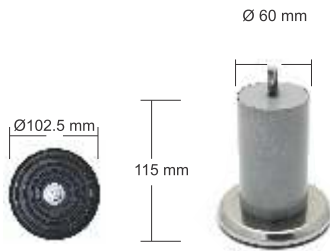

- Screw attachment
- Steel
- Powder coat and chrome finish



137L2T29A-51



137L7T29A-51

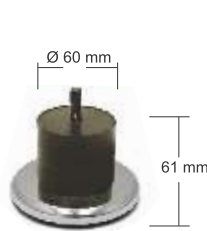

137L5T29PP-51



137L5T29PP-53



CHROMED

137L9T29A-4



137L6T29A-4



137L3T29A-4



137L10T29A-4



CHROMED

137L4T29A-4



137-002-4

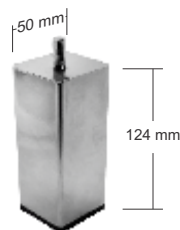

CHROMED PLASTIC ABS

137-001-4



Light weight corrosion free
Non-corrosive



All our products are made in Colombia the norm under ISO 9001:2015 certification by ICONTEC,. All our products include certificate of origin for export.

Please check eligibility of HS code 83.02.20.00 for non duty import tax.

RPPC20X2B17 POLYPROPYLENE AND RUBBER



- RPPC 20" WHEEL
- Vulcanized rubber band
- Polypropylene core
- Double ball bearing
- Long term durability
- 330 lbs load capacity



Polyamide Nucleus reinforced with fiber glass for wheels up to 8". For 10" and 12" wheels, aluminum casting nucleus with.

Poliurethane band for smooth rolling indoors.

- lightweight weels
- minimun effort requiered, smooth Rolling
- super hevvy weight load capacity



**We manufacture over 6,000 products
in a 430,000 sq feet facility.**

For more information contact our sales director



+57 314 894 4244



directorcomercial@multipartes.com



Cra 2a # 21-84 Cali - Colombia.

www.rollercaster.co